

## LED Flasher



### Wiring

To +VDC for Warning Mode (fuse @ 1A):.....**RED**

To Chassis Ground:.....**BLACK**

For Synchronization and Flash Pattern:.....**YELLOW**

Connect **YELLOW** wires of all lighthoods together for synchronization.  
(All lighthoods should be set to the same flash pattern)

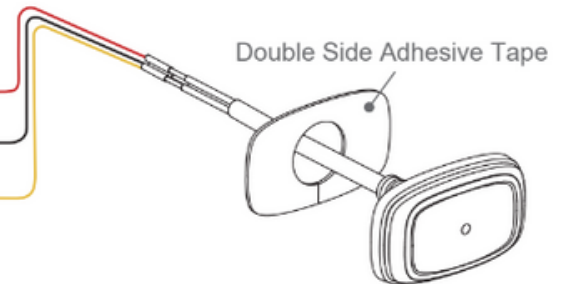

### For Simultaneous or Alternating Flash:

Each Warning Mode may select and save one Flash Pattern. While activating a Warning Mode, momentarily apply **YELLOW** wire to +VDC:

- Once to the next pattern.
- Quick three times to the default Flash Pattern (FP#1).

### For Simultaneous or Alternating Synchronization:

1. Apply +VDC to **RED** and **YELLOW** wires simultaneously to enter SETTING MODE; the lighthouse will display short flashes:

- Single flash = Group 1
- Double flash = Group 2

2. Remove **YELLOW** wire from +VDC then momentarily apply to +VDC to change Groups.

- Lighthoods of the same Group will flash together.
- Lighthoods of the different Group will flash alternately.

### Reset to Factory Default Settings:

1. Apply +VDC to **RED** and **YELLOW** wires simultaneously to enter SETTING MODE;  
2. Remove **YELLOW** wire from +VDC then momentarily apply to +VDC again for more than 5 seconds. The lighthouse will display fast short flashes to signify restoring successfully.

3. Save and exit SETTING MODE by disconnecting all power.

FP#	Flash Patterns	
1	Double	[2Hz]
2	Single	[2Hz]
3	Triple	[2Hz]
4	Quad	[2Hz]
5	Random	
6	Steady EF*	
7	Single	[SAE/CA13]
8	Double	[SAE]
9	Triple	[SAE]
10	Quad	[SAE]
11	Quint	[SAE]
12	Mega	
13	Giga	
14	Ultra	[SAE]
15	Single-Quad	
16	Single H/L	
17	Single-Triple-Quint	
18	Steady Scene	

\* For use with external flash controller.

## Installation

1. Drill a 15mm wire passage hole on the mounting surface. Make sure no vehicle parts could be damaged by the drilling process. (Thoroughly deburr hole and use grommet for wire passage hole if needed)
2. Clean and dry the mounting surface with 50:50 mix of isopropyl alcohol and water.
3. Remove the tape liner from the tape.
4. Apply the tape onto the mounting surface.
5. Align and apply the lighthouse with tape and press it firmly for 30 seconds.
6. Full adhesion and bonding will be achieved after 72 hours at room temperature.

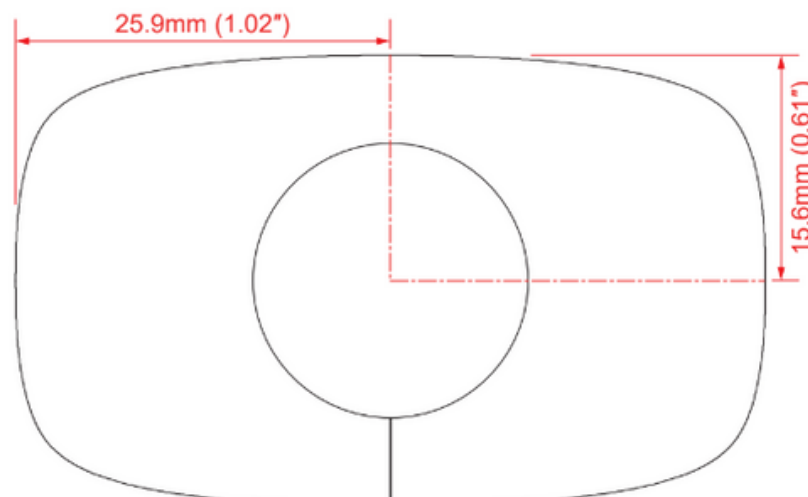

## LED Flasher



FP#	Flash Pattern				
1	Double	[2Hz]	11	Quint	[SAE]
2	Single	[2Hz]	12	Mega	
3	Triple	[2Hz]	13	Giga	
4	Quad	[2Hz]	14	Ultra	[SAE]
5	Random		15	Single-Quad	
6	Steady EF*		16	Single H/L	
7	Single	[SAE/CA13]	17	Single-Triple-Quint	
8	Double	[SAE]	18	Steady Scene	
9	Triple	[SAE]			
10	Quad	[SAE]			

\* For use with external flash controller.